

# HOOD DISHWASHER

803021, 803035, 803036, 803037

v.3.0-09.2021



EN

Instruction manual

Fig. 1

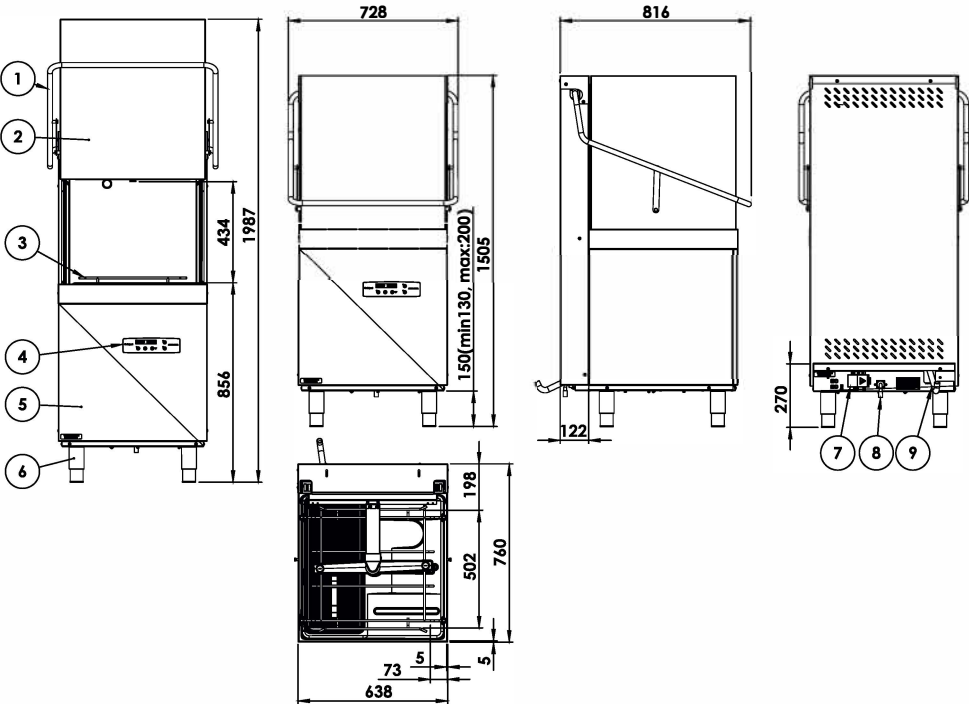

**Thank you for purchasing our product. Please carefully read this instruction manual before first use.**

Reproduction of this manual without the consent of the manufacturer is prohibited.

The photos and drawings are illustrative and may differ from the purchased device.

**CAUTION:** The manual should be kept in a safe place, available to the staff.

The manufacturer reserves the right to change the technical parameters of the device without prior notice.

## 1. SAFETY INSTRUCTIONS

**Failure to follow this instruction may cause life-threatening situations.**

• **CAUTION: If the device was damaged during transport it should not be connected!**

- In the case of a longer break in the operation of the device (night breaks, holiday breaks, etc.) it is necessary to disconnect the device from the electrical power supply.
- Incorrect operation and improper use can cause serious damage to the device or injuries to persons.
- The device should only be used for the purpose for which it was designed.
- The manufacturer assumes no liability for any damages caused by incorrect operation and improper use of the device.
- During operation the device and the power cable plug must be protected against contact with water or other liquids. If the device is accidentally fell into water or was flooded with water, it is necessary to immediately pull out the plug from the socket, and then commission the inspection of the device to an expert technician.
- Do not insert any objects into the openings in the housing of the device.
- Do not touch the power cord plug with wet hands.
- Regularly inspect the condition of the plug and the power cord. In the case any damage to the plug or the cable is found, it should be repaired in an authorized repair point.
- In case the device falls or is damaged in any other way, before further use it is always necessary for it to be inspected and possibly repaired at a specialized repair point.
- Never open the housing of the device by yourself.
- Never try to repair the device by yourself – **it could lead to life-threatening situations.**
- It is prohibited for any changes and repairs to be performed by persons who are not professionally trained.
- Protect the power supply cable from contact with sharp or hot objects and keep it away from open flames.
- When disconnecting the device from the power supply socket, switch off the device first. Always grab it by the plug and never pull by the cord.
- Secure the power cable to ensure that no one pulls it from the socket by mistake and that no one trips over the cable.
- **If the power cord is damaged, it has to be replaced. Non-detachable power supply cords should be replaced at a specialized repair workshop or by a qualified person.**
- Control the operation of the device during use.
- Do not allow for the device to be used by minors, people with physical or mental disabilities and people with impaired mobility, as well as persons without the appropriate experience and knowledge regarding the proper use of the device. Such persons can operate the device only under the supervision of a person responsible for safety.
- If the device is not currently in use or is cleaned, it is necessary to always unplug it from the power source by removing the plug from the socket.
- **CAUTION:** If the plug of the power cord is connected to the electrical socket, the device remains energized.
- Never pull the device by the power cord.
- The device should have a water conditioner installed to protect it from scale build-up
- Professional dishwasher liquids recommended by Stalgast ensure their proper operation
- Use water with a hardness of up to 6 ° dH on a German scale (harder water causes scale build-up on the heaters which may damage and void the warranty)

## 2. PURPOSE OF THE DEVICE

The dishwasher is designed exclusively for professional use and should be operated by trained personnel. The device is used for washing and steaming of utensils (plates, bowls, cups, cutlery, trays, etc.) and other similar items used in catering and related branches, in compliance with international regulations and standards for safety in electrical and mechanical appliances and electromagnetic compatibility.

### 3. TECHNICAL DATA

Unit's equipment (page 2):

1 - Handle, 2 - Hood, 3 - Basket guide, 4 - Control panel, 5 - Body, 6 - Adjustable feet, 7 - Power supply, 8 - Water supply, 9 - Drain hose

Model	803021	803035, 803036, 803037
Dimensions (WxDxH)	728x816x1505 mm	
Supply voltage	400V/3+N+PE	
Frequency	50 Hz	
Maximum power consumption	10,8 kW	
Water supply pressure	200-400 kPa	
Water supply temperature	max. 55°C	
Water hardness in the water supply system	5-6 °dH	
Water consumption	2,5 l/cycle	
Boiler capacity	9,5 l	
Maximum water level in the chamber	175 mm	
Tank capacity	20 l	
Standard cycle duration*	120/180 s	90/120/180 s
Noise level	65 dB(A)	
Protection	IPX1	
Net weight	94 kg	96,5 kg
Type of power cable	H07RN-F 5x2,5mm <sup>2</sup>	
Washing water temperature	55°C (131°F)	60-65°C (140-149°F)
Rinse temperature	30-90°C (86-194°F)	82-90°C (181-194°F)

The dishwasher has an automatic steam function (integral part of the washing cycle).

\* The duration of the cycle is given for the supply water temperature of 50°C.

### 4. INSTALLATION

#### 4.1. Setting the appliance

The appliance must be delivered to the installation site, unpacked, and its condition should be checked. In case of damage to the appliance or any of its components, the shipping company must be notified immediately.

Connections to the devices must conform to the standards in force at the installation site. The manufacturer is not liable for any injury or damage to the product resulting from failure to comply with the standards in force at the installation site. Before installing the appliance, make sure that the moisture-sensitive components are properly protected against wetting, e.g.: during the washing of the appliance.

The appliance should be set at a desired location and then the protective packaging should be removed. The appliance should be leveled using a spirit level and the four adjustable feet, thus ensuring stable operation. Any other way of leveling the appliance should be approved by the manufacturer.

The packaging materials should be kept away from children and pets, as they can cause an accident. All materials used to pack the product are environmentally friendly and can be safely stored in a suitable place. Recyclable components are marked as follows:

- **PE** – polyethylene: external packaging components, manual jacket, fastening components;
- **PP** – polypropylene: grips;
- **Wooden and cardboard** components must be left in places intended for this purpose in accordance with applicable law.

It is forbidden to store the appliance and its components directly in the environment.

#### 4.2. Conditions for connection to the mains:

Check that the mains voltage corresponds to the voltage indicated on the appliance nameplate. The unit should be connected to a mains earth line in accordance with regulations and standards.

#### 4.3. Connecting the appliance to a power source

Connecting the appliance to the mains can only be carried out by the technical service personnel in accordance with applicable law. The electrical parameters of the appliance are included in the table in section 3. It is forbidden to make one electrical safeguard for two appliances. It is necessary to install a main circuit breaker and an earth fault breaker.

Both switches must be installed in an easily accessible location in such a way as to guarantee disconnecting the appliance from power supply in accordance with the category II.

 The appliance is fully disconnected from the power supply only when the main switch is set to OFF. The appliance must be connected via the terminal placed in the rear, lower part of the appliance.

**The power cord connected to the terminal box with and appropriate plug is NOT supplied with the device and must be purchased separately. Conditions for connection to the electrical installation:**

- **Check whether the voltage in the power supply network is consistent with the voltage indicated on the nameplate of the device.**
- The type and type of cable is listed in the table in Section 3.
- The device must be connected to an equipotential equalization system using the equipotential screw (Fig. 5 Pos. 1) on the back of the device. It is marked with the following symbol:

U=400V; P=4500W

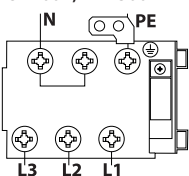

PE – protective wire (yellow-green)

N – neutral wire (blue)

L1, L2, L3 – phase wires (other colors)

**Fig. 2 - Label with connecting diagram**

The supply cable shall be a flexible, oil-resistant cable with a protective conductor, with a polychloroprene sheath - code 60745 IEC 57. It may be prepared by the manufacturer and available from him or from specialized repair shops!

**To connect the device to an electrical equalizing system:**

- loosen the nut on the screw
- enter the equipotential conductor
- tighten the nut all the way
- connect the other end of the equipotential cord to the equalizer.



**Figure 3. Connecting the unit to an electrical equalizing system**

#### 4.4. Connecting the appliance to the water mains

Water hoses and the power cord are protruding from the rear. The water supply hose must be connected to a 3/4" outlet. The connection should be closed only with the use of a brand new hose. In order to observe safety, water pressure should be between 2-4 bar. Should the pressure be higher, a pressure reducer should be installed. The main valve should be installed above the hose feeding water into the appliance. The main valve should be installed in an easily accessible place; therefore, it should not be installed behind the appliance. The appliance is equipped with a drain pipe, which should be installed at floor level with the use of a vent.

**!** Before starting the appliance, make sure that the supply and drain hoses are not bent, blocked or otherwise damaged during installation.

#### 4.5. Drain hole

The device is equipped with a drain pipe which should be installed at floor level with the use of siphon

**!** Before starting the device, make sure that the supply pipe and the drain pipe were not bent, jammed or otherwise damaged during installation.

#### 4.6. First start-up

**!** Before starting the appliance, check the correct operation of the electronic safety system. The above steps and the first start-up may only be done by technical service personnel, who will also conduct a short training in the operation of the appliance. Each appliance is equipped with an adjustable rinse aid dispenser. In contrast, the adjustable washing liquid dispenser is only supplied with some models. A container for the washing liquid and rinse aid must be put in place and then connected to suction tubes: the transparent one to the washing liquid, and the blue one to the rinse aid. To adjust, use the adjustment screws shown in (Fig. 4). It is recommended that adjustments be made by the staff of the company providing the rinse aid and washing liquid. Before connecting the suction tubes, weights should be attached (to keep the tube at the bottom of the container) and filters should be installed (Fig. 5).

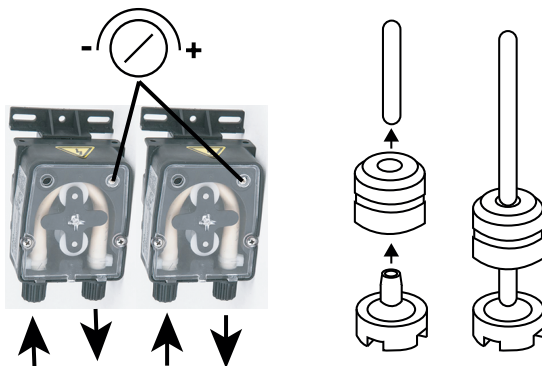

Fig. 4 Fig. 5

In the case where the two liquid dispensers have not been installed before installing the device, it can later be done only by qualified technical personnel (technical service). Alternatively, an external washing liquid dispenser can be connected through an electrical connection via a 2x0.5mm<sup>2</sup> H07 RN-F cable. The cable must be connected through the passage indicated in the technical data diagram, in accordance with the electrical parameters of the appliance and with the laws and regulations in force. Dispenser parameters: 230V/50Hz, 15W. The washing liquid dispenser is connected to the dishwasher through a transparent tube.

### 5. OHS RULES

In order to prevent burns and electrical shock, observe the following safety rules. To do this:

- train staff in the use of the appliance in accordance with the information contained in this manual;
- train staff in basic principles of using electrical equipment, safety at work and first aid in case of an emergency;
- before starting any maintenance work, disconnect the appliance from the power supply,
- prohibit the use of the appliance, if any heating and/or control element has been damaged;
- do not wash under running water.
- only allow qualified technical personnel (technical service) to repair and/or inspect the appliance.

The manufacturer is not liable for any injuries or damage to the product resulting from failure to comply with the recommendations contained in the instruction manual, improper use of the device, use of non-original spare parts and attempts to repair the device independently.

- The device should be connected to an electrical grid with grounding in accordance with the applicable regulations and standards.
- The device complies with the standards introduced under the European Union's Directives. The proper storage of the device is an element of prevention of the pollution of the environment.



Do not add solvents to the dishwasher, such as e.g. alcohol, turpentine, as they could cause an explosion. Also avoid placing dishes with left-over food inside the dishwasher.



The dishwasher and its components should not be used as a ladder or support for other appliances or objects.



Do not sit on or lean against the components of the dishwasher, as this could cause an accident.



The water remaining on the dishes after completion of the cycle is not suitable for drinking.



The device cannot be independently operated by minors and persons with reduced intellectual, physical and sensory capacity, who are not able to fully apply the principles contained in this manual. Operating the appliance by said persons can only take place under supervision.

## 6. OPERATION

### 6.1. Washing and steaming dishes

1. Prior to placing the dishes in the baskets, remove left-over food mechanically and rinse, while dishes with dried food residue should be soaked in water with added detergent and pre-scrubbed using a brush.
2. Set the cycle duration based on the degree of soiling.
3. Place the dishes separately in appropriate baskets, intended for various types of utensils. The basket can hold 12 deep plates or 18 flat plates.

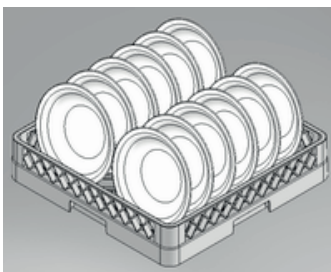
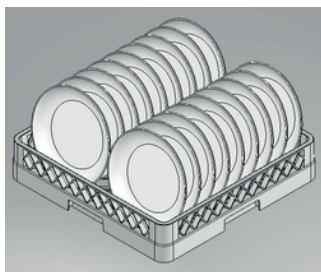

4. The dishes should be arranged in such a way, as to allow as much free flow of water around them as possible. Glasses, cups, bowls should be arranged in a basket or on a tray, their bottoms facing upwards. Cutlery should either be washed in upright position in baskets, or laid down in a flat basket. Do not lay cutlery too densely. Glass utensils should always be washed first.
5. A basket with dishes should be placed in the chamber of the appliance and the door closed. The washing and rinsing process starts automatically. During the washing process, the circulation pump pumps the cleaning solution through the wash arms and nozzles onto the utensils. During its circulation, the cleaning solution constantly flows through the filtration system on its way back to the tank. The rinsing (steaming) cycle is the last stage of washing. Clean dishes are rinsed with fresh, hot water to remove any residual cleaning agent and to heat up the utensils, so they can dry outside the appliance. Water taken for rinsing keeps refreshing the cleaning agent. The door may not be opened during washing. This would create a risk of hot water splashing from inside the appliance. The door of the dishwasher can only be opened 10 seconds after the work has been finished, since this is how long the wash and rinse (steam) arms remain in motion, which may cause splashes and inflict burns on the user.

### 6.2. Dosing detergents

- Only use detergents and rinse aids intended for industrial dishwashers. Do not use agents intended for washing by hand. Their use would result in large amounts of foam in the dishwasher.
- We recommend Stalgast products. They are designed and intended for use with our dishwashers.
- While refilling, make sure not to pour the detergent into the rinse aid container, and vice versa.
- Detergents intended for use in industrial dishwashers are caustic. Follow the information given on the packaging and containers.

Do not mix different detergents. This might damage the dispenser due to crystallization.

### 6.3. WASHING PROCEDURES (803021)

#### 1. Control panel



#### 2. Button functions



Fig. 6

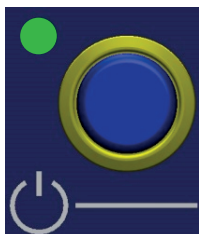

Fig. 7  
On/Off



Fig. 8  
Wash cycle



Fig. 9  
Indicator  
light for chamber  
and boiler  
heaters

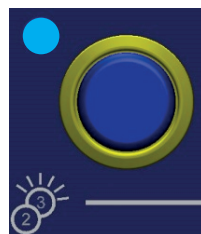

Fig. 10  
Selecting program  
2 - 120 sec. / 3 - 180 sec.

NE

#### 3. Starting the appliance

Activate the switch placed on the wall and press the On/Off (Fig. 7). Then open the hood of the dishwasher, put the overflow plug in place (Fig. 6), put the basket into the chamber and select the program (Fig. 10). After closing the hood, the appliance will start filling its tank and the boiler with water - the boiler pilot light will illuminate (Fig. 9). Once the water in the boiler is heated up, the dishwasher chamber starts heating up the water - a pilot light of the heater compartment light will illuminate (Fig. 9). The washing cycle will start automatically - the indicator light will illuminate (Fig. 8). If you open the door during the wash cycle, the program stops automatically. After closing the door, the program continues the wash cycle. After completing the program, the wash cycle indicator light turns off (Figure 8). Remove the basket from the chamber of the appliance. Note! Each operation that involves closing the hood starts a new dishwashing cycle.

#### 4. Emptying the tank in models equipped with a drain pump

Switch off the appliance by pressing the On/Off switch (Fig. 7), then open the hood of the appliance, remove the overflow plug (fig. 6) and close the hood. The drainage process begins automatically and continues until the tank is completely emptied of water. In order to activate the appliance place the overflow plug back in its place, close the hood of the appliance, and then press the power button. However, if the appliance is not already in use, turn off the main switch.

#### 5. Emptying the tank in models not equipped with a drain pump

Switch off the appliance by pressing the On/Off switch (Fig. 7), then open the hood of the appliance, remove the overflow plug (fig. 6) and wait until the water leaks from the tank completely. Place the overflow plug back in its place, close the hood of the appliance.



In the event of ending work with the appliance, after performing the above, it is mandatory to switch off the device by pressing the switch and then turning off the main switch and close the water tap.



6.4. WASHING PROCEDURES (803035, 803036, 803037)

1. Control panel

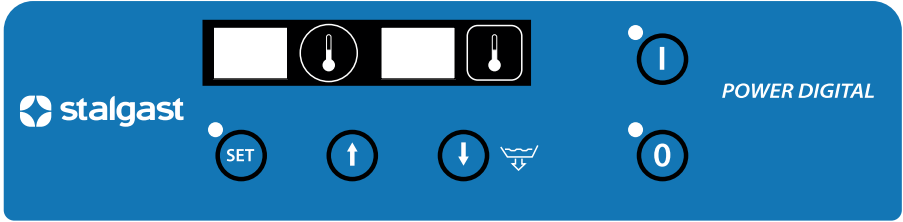

2. Button functions

Start button		<ul style="list-style-type: none"><li>• turns the device on</li><li>• Pressing the button with the door open, launches the STOP function. You can then close the door without starting the washing cycle. To turn the function off, press the button again</li></ul>
Set button		<ul style="list-style-type: none"><li>• confirmation of the introduced input data, setting of the password</li><li>• access to data setting: P1, P2, P3, P4, P5, P6</li></ul>
Down arrow		<ul style="list-style-type: none"><li>• reduces the washing or rinsing temperature</li><li>• drain pump (optional)</li></ul>
Up arrow		<ul style="list-style-type: none"><li>• increases the washing or rinsing temperature and increases the duration of the wash or rinse cycle. C1-90 sec. C2-120 sec. C3-180 sec.</li></ul>
Stop button		<ul style="list-style-type: none"><li>• turns the device off (does not disconnect the device from power supply, the complete disconnection of the device occurs after the plug is removed from the socket or the main external switch is turned off), stops the washing and rinsing process</li></ul>

3. Displays







display 1 – indicates the rinsing and sanitization temperature; washing cycle length C1 – C2 – C3



display 2 – indicates the washing temperature



4. Parameter setting

After the first pressing of  the display will show . Use the  arrows to change the data on display 2 into: . This is the factory-set password.

a. programming of temperatures and times

CUSTOMER SETTINGS





Press  again. The displays will show the following data:  - sanitization-rinsing temperature (70-95°C)



The arrows can be used to adjust the temperature on display 2.





Press again. The displays will show the following data:   - washing water temperature (40-70°C).



The arrows can be used to adjust the temperature on display 2.

### SERVICE SETTINGS (it is recommended that they are not changed)





Press again. The displays will show the following data:   - minimal sanitization temperature (50-90°C).



The arrows can be used to adjust the temperature on display 2.



Press again. The displays will show the following data:   time for water release after the activation of the pressure switch (0-40 sec.) determining the water level.



The arrows can be used to adjust the time of water release on display 2.



Press again. The displays will show the following data:   - sanitization time (8-15 sec.).



The arrows can be used to adjust the sanitization time on display 2.

During the setting of the above parameters the display screen is blinking, and the values of the parameters can be changed using the arrows.

RECOMMENDED SETTINGS		
Function Name	Function description	Recommended value
P1	sanitization (rinsing) temperature	90°C
P2	washing temperature	60°C
P3	minimal sanitization temperature	82°C
P4	time for water release after the activation of the pressure switch	0 seconds
P5	sanitization (rinsing) time	15 seconds

### b. programming of cycle duration



Press Display 1 will indicate:



– the set time is 90 seconds



– the set time is 120 seconds;



– the set time is 180 seconds;

The program is exited automatically 5 seconds after the selection of the desired cycle duration

#### 5. Table of errors

Error code	Error description
EP 1	filling time exceeded, but a second attempt was undertaken
EP 2	double filling time exceeded, attempts terminated
E1 LO	temperature of probe T1 is too low (below 0°C) (or an open circuit in the probe)
E1 HI	temperature of probe T1 is too high (above 110°C) (or a short circuit in the probe)
E2 LO	temperature of probe T2 is too low (below 0°C) (or an open circuit in the probe)
E2 HI	temperature of probe T2 is too high (above 110°C) (or a short circuit in the probe)
E3 LO	temperature of probe T3 is too low (below 0°C) (or an open circuit in the probe)
E3 HI	temperature of probe T3 is too high (above 110°C) (or a short circuit in the probe)
E4	power outage during the operation of the dishwasher
Et	boiler overheating
E1	temperature difference between probe T1 and T2 is too high (>30°C)
E2	safety temperature exceeded – error displayed after the completion of emergency rinsing

#### 6. Start-up of the device

Turn on the switch located on the wall, open the dishwasher door, place the overflow plug in the appropriate place (fig. 8) and close the door of the device. Press the  switch button. After the tank and the boiler are filled with water, the boiler heating element will start operation. After the heating of water in the boiler is completed, the dishwasher chamber water heating cycle will begin. Insert the basket into the device chamber and wait until the water in the chamber reaches the set temperature. Before starting the wash cycle, it is necessary to select the program. The wash cycle is activated automatically by opening and closing the dishwasher door. If the door is opened during the wash cycle, the program stops automatically. After the door is closed, the program continues the wash cycle. The completion of the wash cycle program is indicated by a sound signal from the control board. Remove the basket from the device chamber.

<b>Water for washing</b>	60-65°C (140-149°F)
<b>Water for rinsing/sanitizing</b>	82-90°C (181-194°F)

#### 7. Emptying of the tank in models equipped with a drain pump

Turn the device off by pressing the  switch, then open the door of the device, remove the overflow

plug and close the door. Turn the drain pump on using the  button. The draining process proceeds automatically until the tank is completely emptied of water. In order to reactivate the device, put the overflow plug back in its place, close the door and press the On/Off switch. However, if the device will not be used any more, turn the main switch off.

## 8. Emptying of the tank in models not equipped with a drain pump



Turn the device off by pressing the  the switch, then open the door of the device, remove the overflow plug and wait until the water is drained off completely from the tank. Put the overflow plug back in its place, close the door of the device.



Do not turn the device off when the water is still in the tank. Before turning the device off, always empty the tank of water. In the event the device will no longer be used, after the completion of the above and the possible initiation of a regeneration cycle, it is necessary to turn the device off by pressing the switch. The main switch should then be turned off and the water valve should be closed.

## 7. PROBLEMS, CAUSES, SOLUTIONS

**Note:** if the steps in the table below, aimed to remove the fault, did not produce the desired result, contact your service (qualified technical personnel).

PROBLEM	CAUSE	SOLUTION
<b>The device does not run</b>	Appliance door does not close	Opening and re-closing the door
	Burnt fuse	Replacing the fuse (call for service)
	Improper connection to the power grid	Check the electrical connection
<b>Excessive washing duration</b>	The temperature of the washing water is not right	Setting a suitable temperature
	Abnormal level of water in the appliance	Clean the water inlet filter
<b>The appliance does not wash dishes</b>	Broken washing pump	Call for service
	Low pump pressure	Clean the pump filter
	Water temperature is too low	Correct the water heating time
	Wrong detergent	Contact manufacturer
	Arms covered with limescale or foreign bodies present	Clean the arms and remove foreign bodies
	Empty detergent container	Refill container
	Malfunction in the water treatment unit	Notify service
<b>Stains on the forks, glasses and dishes</b>	Improper arrangement of utensils	Arrange utensils in accordance with instructions
	The temperature of the rinsing water is too high	Setting a suitable temperature
	Incorrect water pressure	Clean filters
	Water hardness too high	Check water hardness
	Cleaning agent did not work due to the dirty water in the machine	Change water in the appliance
	Dishes drying improperly	Change water in the appliance
	Wrong rinse aid	Contact manufacturer
<b>Dishwasher does not rinse</b>	Dirty water inlet filter	Clean the filter
	Low water pressure	Clean the pump filter and solenoid valve
	Faulty rinsing pump	Call for service
<b>Solenoid valve leaking</b>	Contamination of the solenoid valve	Call for service Note: When installing the appliance, foreign material or undesirable chemicals from the water supply could have been trapped in the solenoid valve.

PROBLEM	CAUSE	SOLUTION
The water pressure in the appliance is too low	Contaminated water inlet filter or solenoid valve	Clean the water inlet filter or solenoid valve
	Low water pressure in the water supply	Contact a plumber
The pump does not pump out water	Pump clogged	Contact service
	Faulty pump	

## 8. MAINTENANCE



Before starting any maintenance work, disconnect the appliance from the power supply.

Daily maintenance involves removing objects from the chamber and washing them with a cloth dampened in water with a dish detergent and then wiping them off with a dry cloth. Washing under running water as well as using a pressure washer for this purpose is prohibited.

In the case of intense use, we recommend that you clean the filters every 30-40 wash cycles in order to ensure the proper functioning of the appliance. To do this, partially drain the tank of water.

Remove the filters, making sure no fatty deposits and left-over food falls into the openings under the filters. Clean the filters of food residue and sediment and then rinse thoroughly. Do not use sharp tools or sharp edges to clean the filters. Make sure to also remove limescale, as this prevents the build-up of a layer on the surface of the filter.

The surfaces of the filters should be cleaned thoroughly with a damp cloth and neutral (non- aggressive) detergents with no chlorine content and agents that do not cause corrosion and mechanical damage to stainless steel surfaces.

In order to prevent the formation of corrosion spots on the stainless steel, avoid using harsh detergents containing chlorine and agents that cause corrosion or mechanical damage to the stainless steel surfaces. For cleaning floors and immediate surroundings, only use detergents that do not cause damage to stainless steel.

### Once a month you should:

- make sure the power cord is not damaged;
- make sure that all components of the appliance are working properly,
- remove the washing arms (Fig. 11) (bottom and top 1 and 2) by loosening the screw (3) and clean under the current water

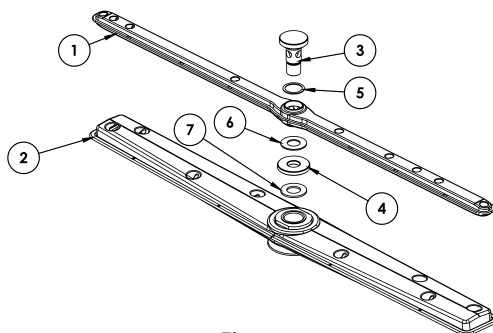

**Fig. 11**

- Clean the outside of the appliance using a washing liquid for stainless steel and a damp cloth and then thoroughly rinse and wipe dry.

Service the appliance at least once a year to verify its correct operation, determine the degree of wear, detect possible failures of components and parts. If you detect any damage, it should be removed by qualified technical personnel (technical services). Technical service should pay particular attention to:

- the condition of heating elements,
- the condition of electrical installation,
- the condition of heating elements' safeguards,
- wear and tear of the appliance,

Any damage or failure resulting from the user's non-compliance with this manual as well as failure to comply with existing legislation and standards will not be considered manufacturer's liability.

### Downtime in operation

When not expecting to use the appliance for an extended period of time, it is necessary to empty containers for the washing liquid and rinse aid in order to prevent crystallization and, consequently, damage to the pump. Accordingly, suction tubes should be removed from both containers and placed in a bowl filled with clear water; carry out several wash cycles and then drain the tank of water. Finally, turn off the main switch and close the water tap. Suction tubes must be connected back to the containers only when the appliance goes back into use (the clear tube goes into the washing liquid container, and the blue one into the rinse aid container).

**It is forbidden to leave the appliance on and the water valve open for an extended period of downtime.**

**In winter period, the device must be stored in a heated room. Otherwise, make sure that no fluids have remained in the device (e.g. boiler, detergent pipes).**

## 9. DISPOSING OF USED EQUIPMENT

**Information for users about the proper principles of disposal of waste electric and electronic equipment**

- **Leave the old device in the store where you are buying a new device.** Each store has an obligation to take your old equipment free of charge if you buy new equipment of the same type and in the same quantity. The only condition is to deliver the equipment to the store at your own expense.
- **Take the used device to a collection point.** You will find information about the nearest location on the municipal website or bulletin board of the municipal office.
- **Leave the device at the service point.** If the repair of the device is uneconomical or impossible for technical reasons, the service is obliged to accept the device free of charge.
- **Return used equipment without leaving your house.** If you don't have the time or ability to transport your equipment to a collection point, you can use the services of specialized companies.

**Remember! Do not dispose of used equipment along with household waste. This could cause high fines.**



The symbol of the crossed-out waste bin on the product, its packaging or the instruction manual means that the product should not be disposed of to normal waste bins. The user is obliged to hand over the used equipment to a designated collection point for proper processing.

## 10. WARRANTY

The seller shall be liable under the warranty or guarantee.

Damage resulting from the formation of lime scale deposits in the device are not subject to repair under the warranty.

Warranty exchange does not cover such elements as: light bulbs, rubber components, heating elements damaged by lime scale, screws and elements undergoing natural wear, e.g. rubber seals and all kinds of mechanically damaged elements. Any damage of components resulting from improper use is also excluded from the warranty.

The warranty is automatically voided in the event of a broken warranty seal or independent repairs.





**stal**gast

ekspert gastronomiczny



**inox**-bázis  
*Rozsdamentes* KONYHATECHNOLÓGIA

**Inox-Bázis Kft.**

e-mail: [info@inoxbasis.hu](mailto:info@inoxbasis.hu)

Tel: +36 1 788-1828

9090 Pannonhalma, Arany János u. Központi major