

Instructions for use Countertop display refrigerators

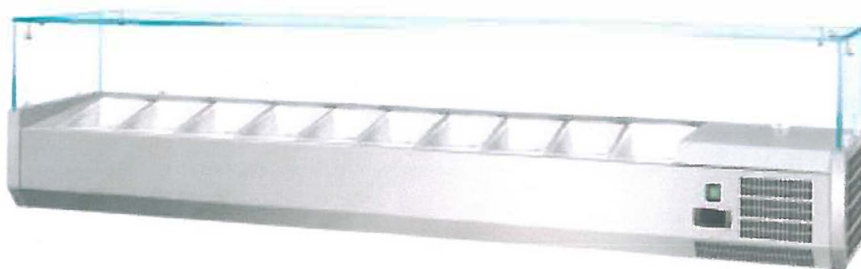

VRX series

SAFETY REGULATION



Important: For your own safety, read the instructions carefully.

Keep the instruction manual for future reference.

Place the device on a flat, solid surface.

It is recommended for the assembly and repairs to be carried out by an expert.

Do not remove original parts.

Read the instructions carefully to ensure compliance with regional and international regulations:

1. Health and safety legislation.
2. Fire protection.
3. IEE cable network specifications.
4. Construction regulations.
5. Use the equipment correctly.
6. DO NOT use the equipment outdoors.
7. If the equipment malfunctions, DO NOT attempt to repair it yourself.
8. DO NOT use the device if the equipment is damaged, call a specialist for help.
9. DO NOT use other equipment in the device (ie: ice cream maker, heater, etc.) unless recommended by the manufacturer.
10. DO NOT block or obstruct ventilation openings.
11. DO NOT use cooling accelerators in the machine, unless recommended by the manufacturer.
12. DO NOT damage the cooling circle.
13. DO NOT stand or lean on the device/glass panel.
14. If oil or grease gets on the plastic parts, clean them immediately.
15. DO NOT put flammable, explosive, corrosive acids or alkalis into the device.
16. DO NOT use the equipment to store sanitary products.
17. DO NOT use high-pressure cleaners when cleaning.
18. DO NOT allow children to play with the packaging, dispose of the waste properly.
19. Always store, move or use the machine in a horizontal position.
20. Always unplug the equipment when cleaning.
21. If the power cord is damaged, replace it immediately or call an expert.
22. The use of the equipment is not recommended for people with physical, mental or nervous system problems, this also applies to inexperienced users, the equipment can only be used with supervision or permission.
23. Children may only use it under supervision.
24. To ensure proper operation, use the machine only if it is assembled as described in the safety instructions.
25. All maintenance operations may only be performed by experts.

ASSEMBLY

- Unpack the device. Make sure all packaging layers are removed.
To avoid accidents and injuries, unpack the equipment by two people.
- Keep a distance of 20 cm between objects or walls and the equipment for proper air circulation. If the object is a heat generating unit, increase the distance.
- Adjust the height using the twistable legs. The ideal base is a level, solid plinth to reduce vibration and sound.
- The place where the machine is set up must be between 10 and 32°C. Avoid direct contact with sunlight and placement near heat radiating units.
- Make sure that everything is in place for proper air circulation of the equipment.
- For power supply, follow the instructions on the input. The connector must be accessible after assembly.
- Plug and unplug the outlet properly when in use. Make sure that the device is properly plugged in. When unplugging, always pull the handle of the connector, never the cable.
- If the equipment is to be stopped for a longer period of time, switch it off, unplug it, clean it and fold down the cover to avoid the smell.
- Important! This equipment must be equipped with protective earthing. If you are not sure whether the product is properly grounded, contact a professional to help with the wiring.
- In the event of a power failure, wait 3 minutes before switching back on to prevent damage to the compressor.

Inserting the glass



Attention: Breaking the glass panel can be dangerous

ASSEMBLY

- Carefully unpack the wooden/cardboard box, it is recommended that two people carry out the process.
- Screw the glass holders into the panels.
- Insert two sheets of glass into the glass support panels with the hole on the glass facing up.
- Secure the glass panels by tightening the glass retaining screw.
- Insert the side panel into the glass holder with the hole on the glass facing up.
- Secure the glass panels by tightening the glass retaining screw.
- Insert the plastic rivets into the holes.
- Tighten all screws using the given screw set.
- Place the roof panel on top, making sure all holes are facing up.
- Secure the glass panels by tightening the glass retaining screw.

Assembling a glass panel

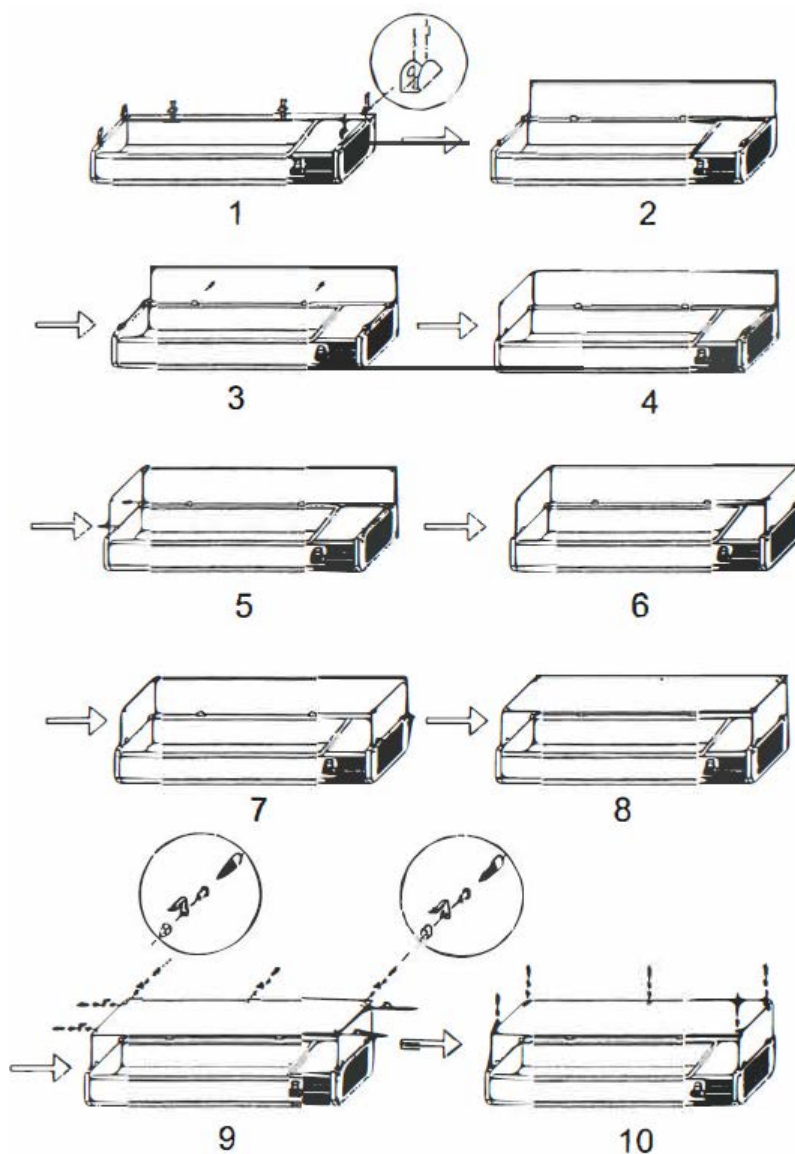

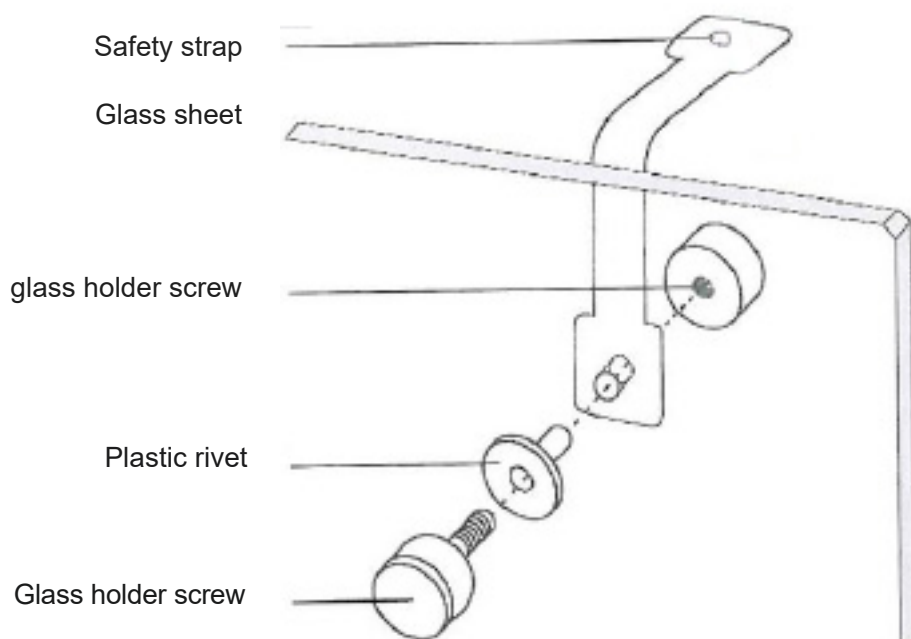

USAGE

Food storage

For best results, follow these instructions:

- Only store food in it when the device reaches the correct temperature.
- Always insert GN containers, even if the container is empty, empty container holders can greatly reduce the performance of the machine.
- Always keep doors, hatches closed when not in use.
- Never place uncovered hot food or drink in the appliance.
- Wrap or cover up the food whenever possible.
- Do not obstruct the operation of the fans in the machine.
- Avoid leaving doors open for long periods of time.
- The maximum load capacity is 20 kg.
- After the food has cooled down, it can only be stored in the toppings cooler.
- Ice appearing on food and vegetables placed in the refrigerator is normal.

Turning on

- Close the door.
- Make sure the power button is set to [O].
- Turn on [I]. The current temperature is shown on the display.

USAGE

Temperature adjustment and management The front panel of the thermostat

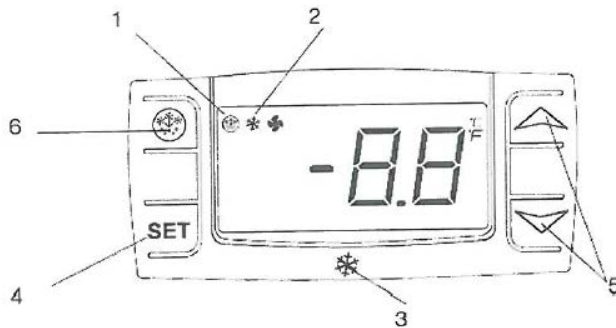

1. Defrost mode
2. Compressor operation mode
3. Digital thermostat
4. Programming button (For experts only)
5. Temperature setting button
6. Manual defrost

How to see the set temperature:

Press the **SET** button and release immediately, the temperature will be displayed on the panel
Press again and release immediately or wait 15 seconds to return to the normal menu

How to change the temperature:

Press the **SET** button, keep it pressed for more than 2 seconds.
The temperature appears on the display and the flashing "C0" indicates the setting.
Use the up and down arrows to set the temperature within 10 seconds.
To save the entered value, press the **SET** button or wait 10 seconds.

Defrosting:

The equipment automatically performs a cycle every 12 hours.

Note: The cycle is calculated from the last time the machine was switched on.

To manually defrost, press the **DEFROST** button for 5 seconds.

The cycle starts automatically, the process takes 20 minutes.

Note: Manual defrost will restart the automatic defrost cycle timer.

CLEANING, CARE AND MAINTENANCE

Routine maintenance

Switch off and unplug the machine before cleaning.

- Clean the casing and interior as often as possible
- Clean with a damp cloth. Never allow the panel, cable or connector to get wet.
- Do not use strong detergents, slightly soapy water is optimal. Make sure that water never touches the electronic parts. Do not clean with high-pressure equipment.
- Always wipe dry.
- Pay special attention to cleaning the back side.
- An expert must carry out repairs if necessary.
- If you do not use the machine for an extended period of time, turn it off, unplug it and clean it thoroughly.

Special maintenance

The instructions in this section are intended for use by qualified personnel only

- Periodically clean the condenser with the appropriate tools (vacuum cleaner or soft brush).
- Check that the electronic parts are not loose.
- Check that the thermostat and sensor are working in the correct sequence

Circuit diagram:

P1	POWER PLUG
S1	MAIN SWITCH
TH1	HEATER SWITCH
C1	COMPRESSOR
QF1	OVERLOAD
R1	RELAY
F1	CONDENSER FAN
SQ1	TEMPERATURE PROBE

